



14 Pin DFB Butterfly Laser – ITU Grid

Description

A multi-quantum well (MQW) DFB Laser in a 14 Pin butterfly package. This DFB laser features high output power, good Side Mode Suppression Ratio (SMSR) and a built in Peltier Thermoelectric Cooler (TEC) as well as a built-in photodiode for power monitoring.

Features

- High output power 1 – 300 mW
- Built in monitor Photodiode
- 1 MHz, 500 KHz, 300 KHz, 100 KHz Linewidths available
- Available wavelengths
 - ITU Grid Spacing
- High Linearity
- RoHS compliant
- Built-in TEC
- 10 K Ω Thermistor
- Ability to choose desired optical connector.
- Ability to choose desired Optical Power



Applications

- Long Reach Analog Transmission Systems
- Test Equipment
- Optical Communication

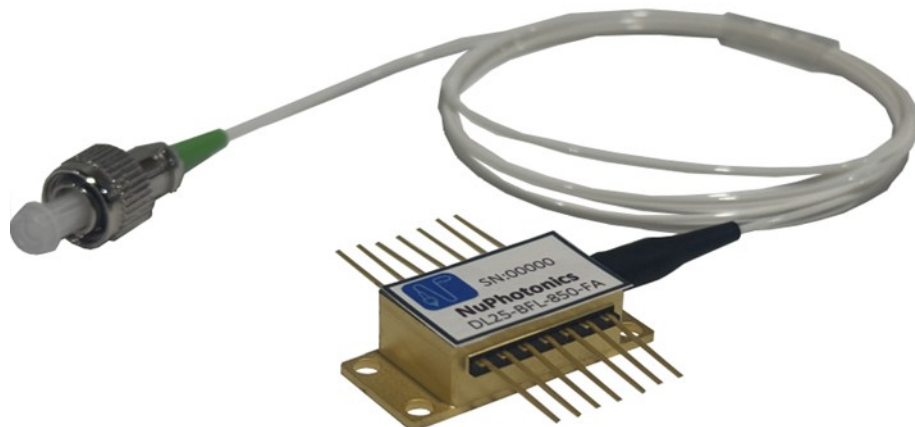

IMPORTANT NOTICE: more information on warranty, changes, rights, notices, and other information are presented at the back of this data sheet. If the back sheet is not present, refer to www.nuphotonics.com for the company issued data sheet.

Electro-Optical Characteristics (Top 23 ± 3 σ , unless otherwise specified)

Parameter	Symbol	Condition	Min.	Typical	Max.	Unit
Forward Voltage	V_r	Laser	-	-	2	V
Forward Current	I_F	P_{cw} 10 mW	-	70	-	mA
Threshold Current	I_{th}	25°C	-	5	15	mA
Monitor Current	I_{mon}	10 mW	-	175	-	μ A
Reverse Current	I_R	Photodiode	-	-	2	mA
Optical power	P_{cw}	25°C	1	-	30	mW
Central Wavelength	λ_c	25°C	$\lambda_c-0.2$	λ_c	$\lambda_c+0.2$	nm
Side Mode Suppression Ratio	SMSR	25°C P 10 mW	-	48.3	-	dB
20 dB Bandwidth	$\Delta\lambda$	25°C	-	250	-	nm
Rise/Fall	T_r/T_f	10-90/90-10	-	2	-	ns
Tracking Error	E_r	25°C	-	1	-	dB

Absolute Maximum Ratings

Parameter	Symbol	Condition	Min.	Max.	Unit
Reverse Voltage	V_r	Laser		2.4	V
		Photodiode		10	
Forward Current	I_F			150	mA
Reverse Current	I_R	Photodiode		2	mA
Optical Output power	P_{cw}			45	mW
Storage Temperature	T_{stg}		-25	90	°C
Storage Humidity	H_{stg}			85	% r.H.
Operating Temperature	T_{op}		-25	80	°C
Soldering Temperature	T_{st}	60 sec		200	°C
ESD Susceptibility		HBM	100		V

Operating at maximum ratings for a prolonged period will cause damage to the device.



Pin Configuration

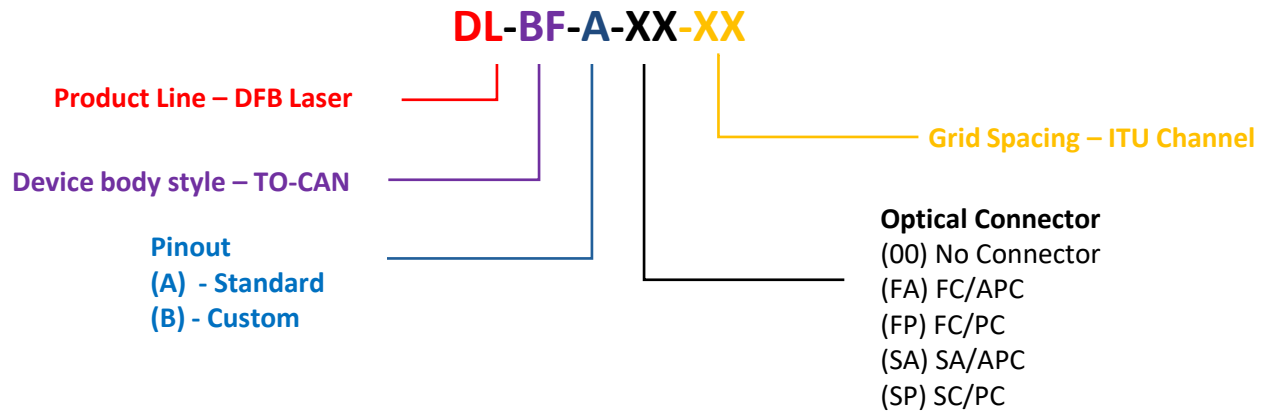

Example – DL-BF-A-FA-27

DFB Laser 14 Pin Butterfly Standard Pinout FC/APC Channel 27 (1555.75 nm / 192.27 THz)

Channel Number	Frequency (THz)	Wavelength (nm)	Channel Number	Frequency (THz)	Wavelength (nm)
18	191.8	1563.05	42	194.2	1543.73
19	191.9	1562.23	43	194.3	1542.94
20	192	1561.42	44	194.4	1542.14
21	192.1	1560.61	45	194.5	1541.35
22	192.2	1559.79	46	194.6	1540.56
23	192.3	1558.98	47	194.7	1539.77
24	192.4	1558.17	48	194.8	1538.98
25	192.5	1557.36	49	194.9	1538.19
26	192.6	1556.55	50	195	1537.4
27	192.7	1555.75	51	195.1	1536.61
28	192.8	1554.94	52	195.2	1535.82
29	192.9	1554.13	53	195.3	1535.04
30	193	1553.33	54	195.4	1534.25
31	193.1	1552.52	55	195.5	1533.47
32	193.2	1551.72	56	195.6	1532.68
33	193.3	1550.92	57	195.7	1531.9
34	193.4	1550.12	58	195.8	1531.12
35	193.5	1549.32	59	195.9	1530.33
36	193.6	1548.51	60	196	1529.55
37	193.7	1547.72	61	196.1	1528.77
38	193.8	1546.92	62	196.2	1527.99
39	193.9	1546.12	63	196.3	1527.22
40	194	1545.32	64	196.4	1526.44
41	194.1	1544.53			



Pin Configuration

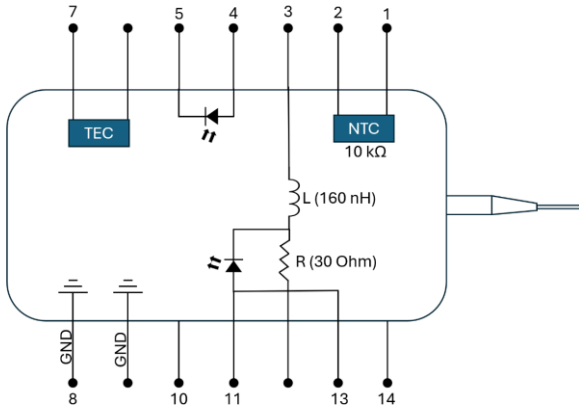

Pin Number	Function	Pin Number	Function
1	Thermistor	8	GND
2	Thermistor	9	GND
3	LD Cathode (-)	10	No Connect
4	PD Anode (+)	11	Laser Anode (+)
5	PD Cathode (-)	12	Laser Cathode (-)
6	TEC (+)	13	Laser Anode (+)
7	TEC (-)	14	No Connect

Mechanical Drawing

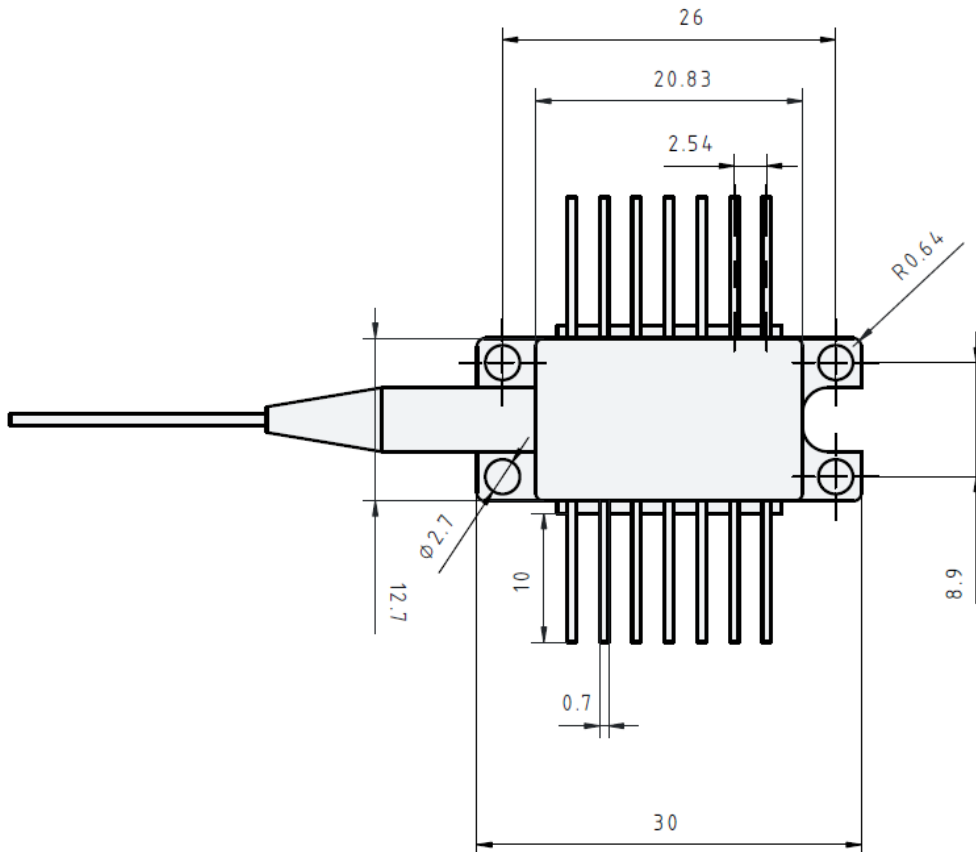
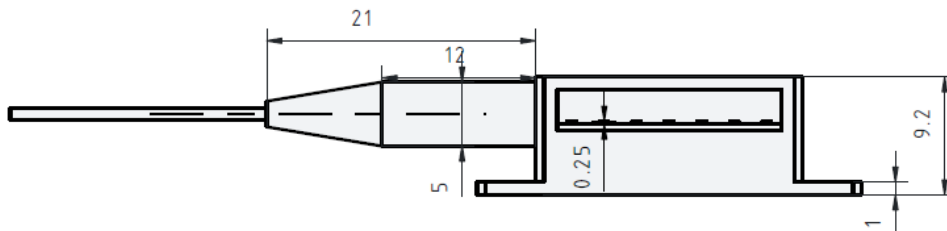

IMPORTANT NOTICES AND DISCLAIMERS

Information and Warranty Disclaimer

NuPhotonics provides technical and reliability information, including datasheets, design files, application notes, and other materials (collectively, “Resources”), to assist designers who are developing applications that incorporate NuPhotonics products. These Resources are provided “as is” and “with all faults.” NuPhotonics makes no warranties or representations, express or implied, regarding the Resources, including, without limitation, accuracy, completeness, reliability, or fitness for a particular purpose. NuPhotonics disclaims all implied warranties, including warranties of merchantability, fitness for a particular purpose, and non-infringement of third-party intellectual property rights.

Use of Resources

These Resources are intended for use only by skilled and qualified developers. The customer is solely responsible for selecting appropriate NuPhotonics products and for designing, validating, and testing their applications. The customer is further responsible for ensuring that their applications meet all applicable standards, safety requirements, and regulatory obligations.

Changes and Availability

NuPhotonics reserves the right to make corrections, modifications, enhancements, improvements, and other changes to its Resources and products at any time and without notice. NuPhotonics may discontinue any product or Resource without notice.

License and Restrictions

NuPhotonics grants a limited, non-exclusive, non-transferable license to use the Resources solely for the purpose of developing applications that incorporate NuPhotonics products. No other license, express or implied, is granted, including any license to third-party intellectual property. Reproduction, distribution, or display of the Resources, in whole or in part, without prior written permission from NuPhotonics is prohibited.

Limitation of Liability and Indemnification

In no event shall NuPhotonics be liable for any direct, indirect, incidental, special, consequential, or exemplary damages arising out of the use of the Resources. The customer agrees to defend, indemnify, and hold harmless NuPhotonics from and against any claims, damages, costs, losses, and liabilities arising from the customer’s use of the Resources or products.

Terms and Conditions

NuPhotonics objects to and rejects any additional or different terms proposed by the customer. For complete terms and conditions of sale, refer to the Legal section at www.nuphotonics.com.

Definitions: Product State

Alpha Build – Device is in internal engineering development and testing. Specifications are subject to significant change.

Beta Build – Device is available for external evaluation and engineering sampling. Specifications are subject to minor change.

Production Build – Device is released for production. Minor cosmetic or appearance variations may occur.

Obsolete – Device is no longer in production and is not supported.

Copyright © 2026, NuPhotonics LLC

Revision History

1.1 – May 2026 – Initial release